

## / Unlock

### 1. Remove the Screws

The figure below shows the location of the cover screw.  
Unscrew and remove the cover screw with the provided T-Wrench.

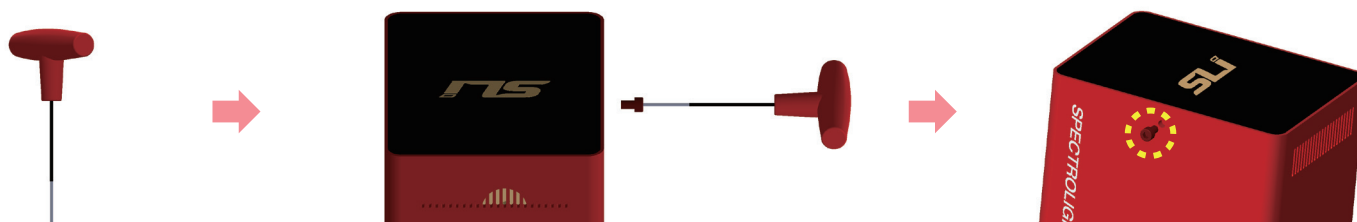

*The cover screw is used to protect inner parts from dust and other external substances.*

### 2. Release the motor rotation breaks

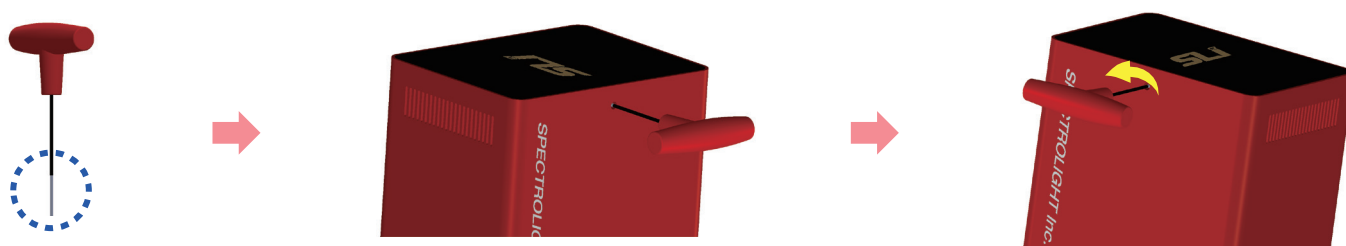

**Insert the T-Wrench into the hole until the SILVER SECTION of the wrench is INSERTED ALL THE WAY inside the hole. Afterwards, turn the wrench COUNTER CLOCKWISE (to the left) around a few times as shown in the figure above.**

## / Lock

### Repeat the Unlock Steps

Go over all the steps of the "Unlock" process.  
However, during the "release the motor rotation breaks" step, **turn the T-Wrench CLOCKWISE (to the right)** to apply the motor rotation brakes.

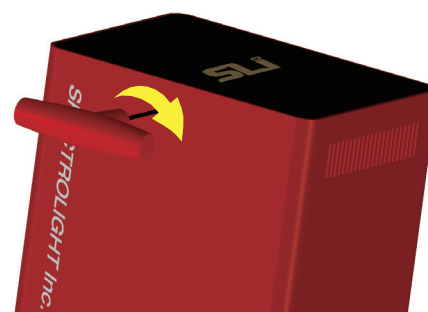

*When shipping or transporting the device, it is a MUST to lock the device by applying the motor rotation brakes. There is a high chance of critical damage of the inside components during shipping if the motor rotation brakes are NOT applied.*